

CERTIFIED RECORD OF LAND CORNER MONUMENTATION

6

History of original corner establishment:

Established in 1883 by Henry W. Cooke under contract no. 488, dated August 11, 1883. Surveyor General's records state:

Set a basalt stone 20x16x4 ins 15 ins in ground for 1/4 sec cor marked 1/4 on N. face and raised a mound of stone 3/2 ft high 4 1/2 ft base alongside.

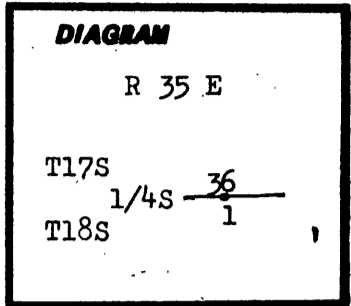

Description of corner evidence found:

At the assumed corner location I found a rock with a visible "1" on the N. face. The remaining "1/4" had been broken off.

Description of monument and accessories I established to perpetuate the original location of this corner:

At the location of the marked rock I set a standard USFS all aluminum corner monument, consisting of a 3" disk mounted on a 2 1/2 x 30" pipe with a flared base, buried 14 inches with a 4 ft diameter mound of rock surrounding it. The marked rock is buried alongside the monument. Disk is stamped as shown. Set July 2, 1982, witnessed by Pedro Zabala.

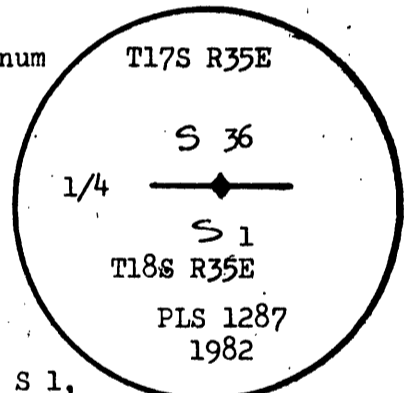

BT's established:

- a 14" West. Juniper bears N. 40°30' E, 37.8 ft distant, scribed 1/4 S 36, BT
- a 10" West. Juniper bears S. 57° W, 85.6 ft distant, scribed 1/4 S 1, BT.

Both BT's are banded with red paint, carry BT and Attention signs and have a brass disk stamped PLS 1287 nailed at the base of the BT blaze.

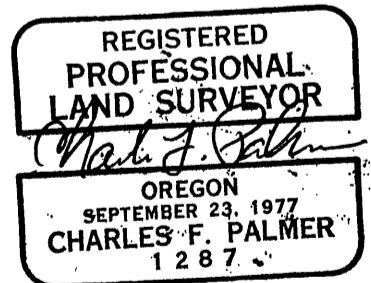

Office of Surveyor County of Harney
 State of Oregon I hereby certify that the within instrument was filed in this office
 for record on the 3rd day of Nov., 1982
Charles F. Palmer by _____
 (COUNTY OFFICIAL) (DEPUTY)

Harney Co. Survey No 168
 Grant Co. Survey No 736